

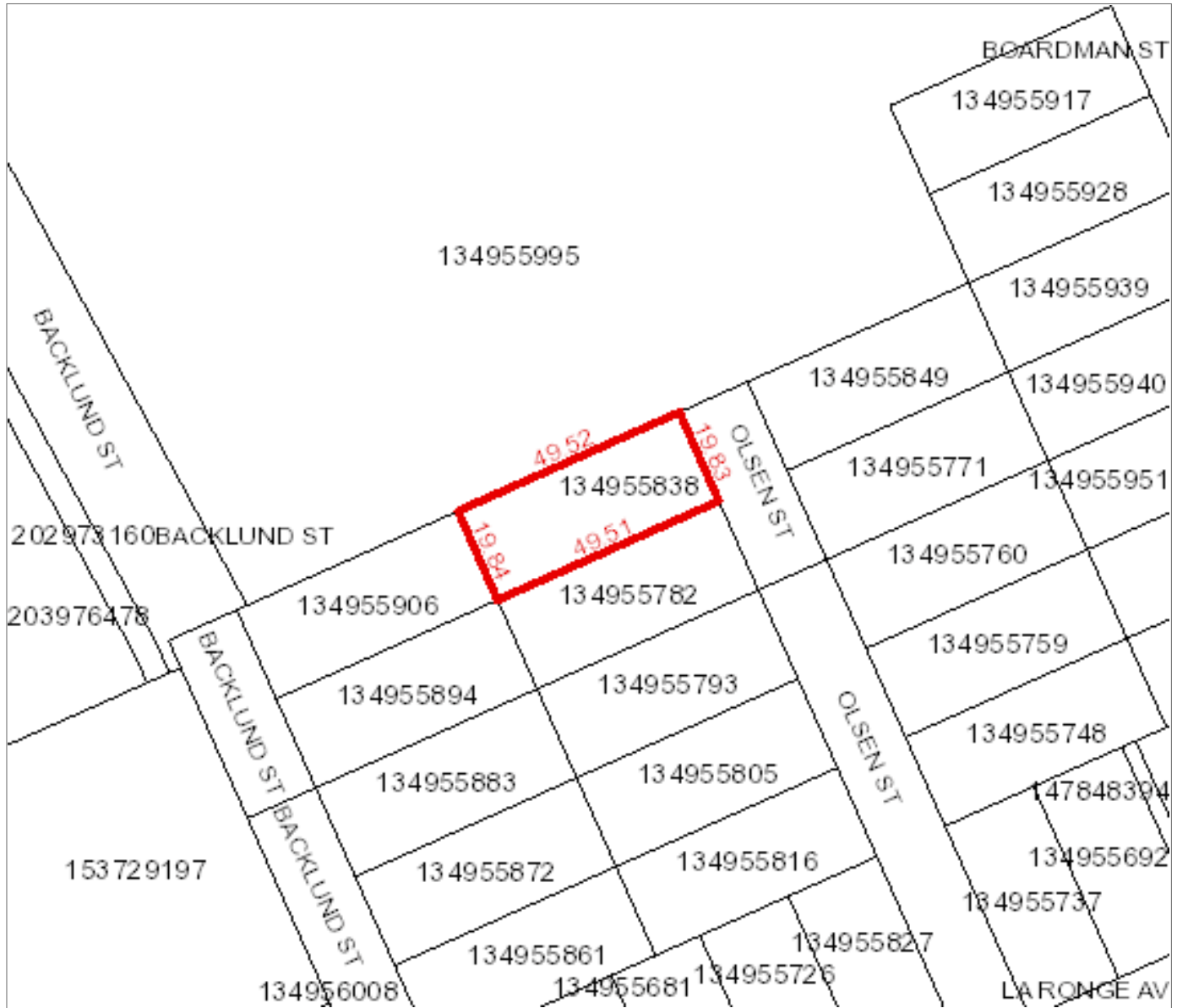

Surface Parcel Number: 134955838

REQUEST DATE: Wed Feb 5 14:08:18 GMT-06:00 2025



Owner Name(s) : Town of La Ronge

Municipality : NORTHERN TOWN OF LA RONGE

Title Number(s) : 117170872

Parcel Class : Parcel (Generic)

Land Description : Lot 15-Blk/Par 14-Plan CR3862 Ext 0

Source Quarter Section :

Commodity/Unit : Not Applicable

Area : 0.098 hectares (0.24 acres)

Converted Title Number : 66PA04083

Ownership Share : 1:1